

Alea Privighetorilor

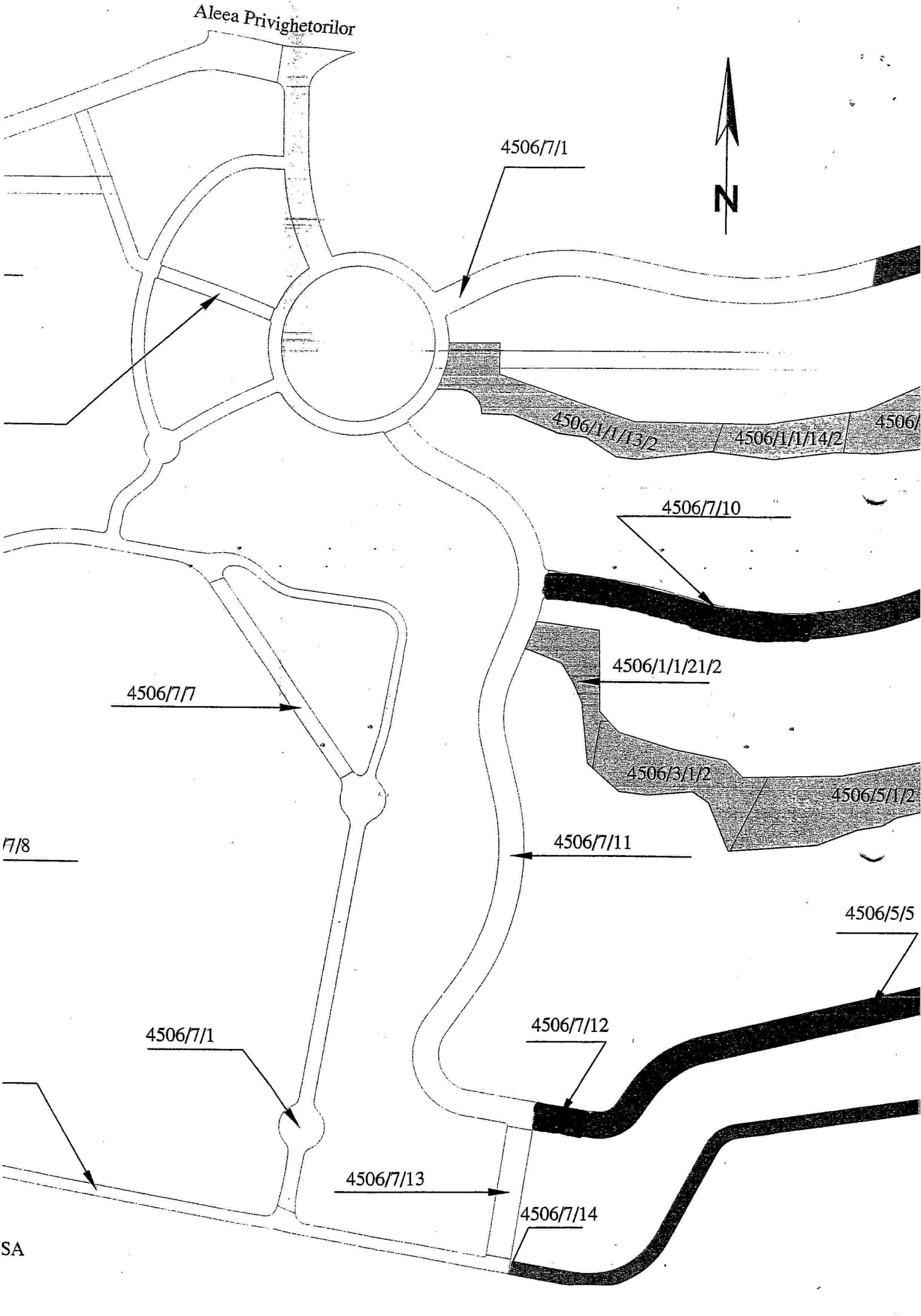

4506/7/1

4506/1/1/13/2

4506/1/1/14/2

4506/

4506/7/10

4506/7/7

4506/1/1/21/2

4506/3/1/2

4506/5/1/2

4506/7/11

7/8

4506/5/5

4506/7/1

4506/7/12

4506/7/13

4506/7/14

SA

SCHITA DE AMPLASARE

A SUPRAFETELOR DE TEREN CE URMEAZA A FI DONATE

SCARA 1 : 5000

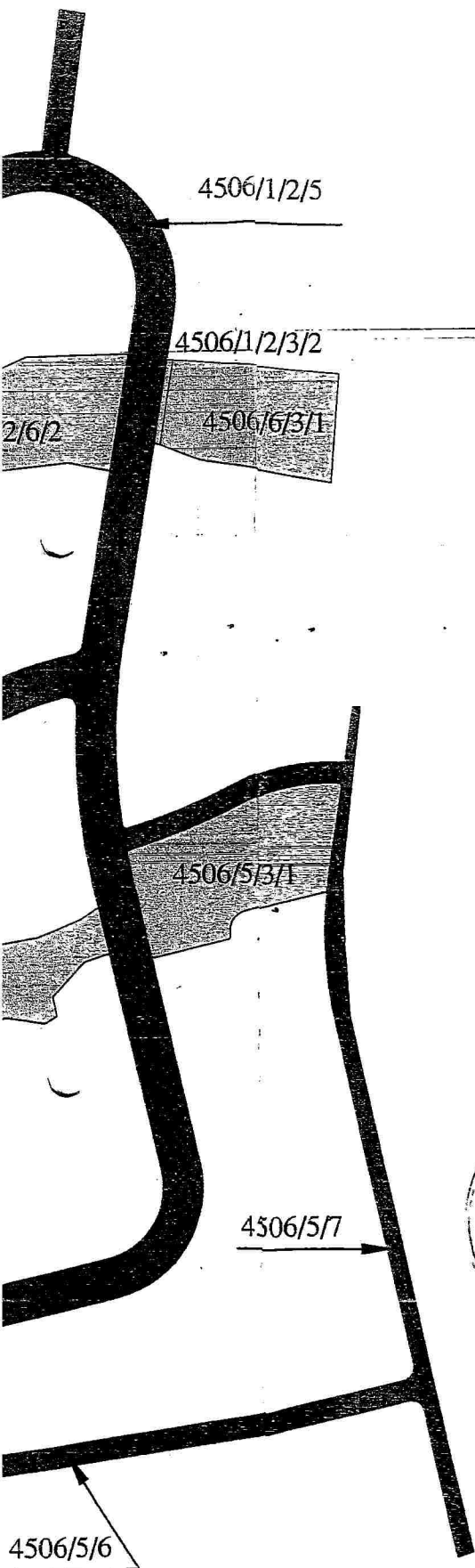

RECAPITULATIA SUPRAFETELOR

4506/7/3 =	4251,61 mp
4506/7/4 =	3079,98 mp
4506/7/10 =	8896,74 mp
4506/7/12 =	1743,22 mp
4506/1/2/5 =	26 365,12 mp
4506/5/5 =	28 234,35 mp
4506/5/7 =	7 093,31 mp
4506/5/6 =	13 255,10 mp
4506/1/1/13/2 =	13 941,07 mp
4506/1/1/14/2 =	5 842,96 mp
4506/1/2/6/2 =	13 235,68 mp
4506/1/2/3/2 =	317,88 mp
4506/6/3/1 =	9 802,38 mp
4506/1/1/21/2 =	5 570,64 mp
4506/3/1/2 =	10 975,67 mp
4506/5/1/2 =	18 025,13 mp
4506/5/3/1 =	12 943,08 mp

TOTAL = 183573,93 mp

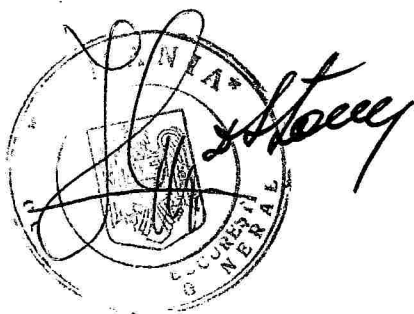

ANEXA 1

Data 29.11.20

Sos. Bucuresti - Ploiesti

Aleea Privighetor

PARCELA 3
NR. CAD: 4506/7/6

PARCELA 1
NR. CAD: 4506/7/1

PARCELA 2
NR. CAD: 4506/7/2

PARCELA 1

AEROPORTUL BANEASA

Sos. Bucuresti - Ploiesti

Aleea Privighetor

PARCELA 3
NR. CAD: 4506/7/6

PARCELA 1
NR. CAD: 4506/7/1

PARCELA 2
NR. CAD: 4506/7/2

PARCELA 1

AEROPORTUL BANEASA