

DATELE DE IDENTIFICARE ALE IMOBILELOR
declarate ca bunuri aparținand domeniului public al Municipiului București

Nr. crt.	Amplasament imobil	Elemente identificare	Destinație
1	București, Șos. Mihai Bravu, F.N., sector 4	Suprafață = 1843 mp.	Domeniul public
2.	București, Str. Alexandru Ivasiuc, F.N., sector 6	Suprafață = 5941 mp.	Domeniul public

CONFORM
cu ORIGINALUL

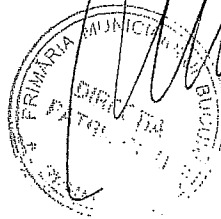
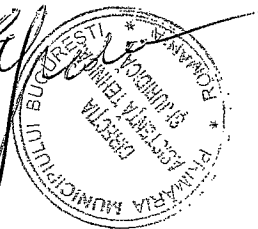

Planul nr. 12.11.2.12

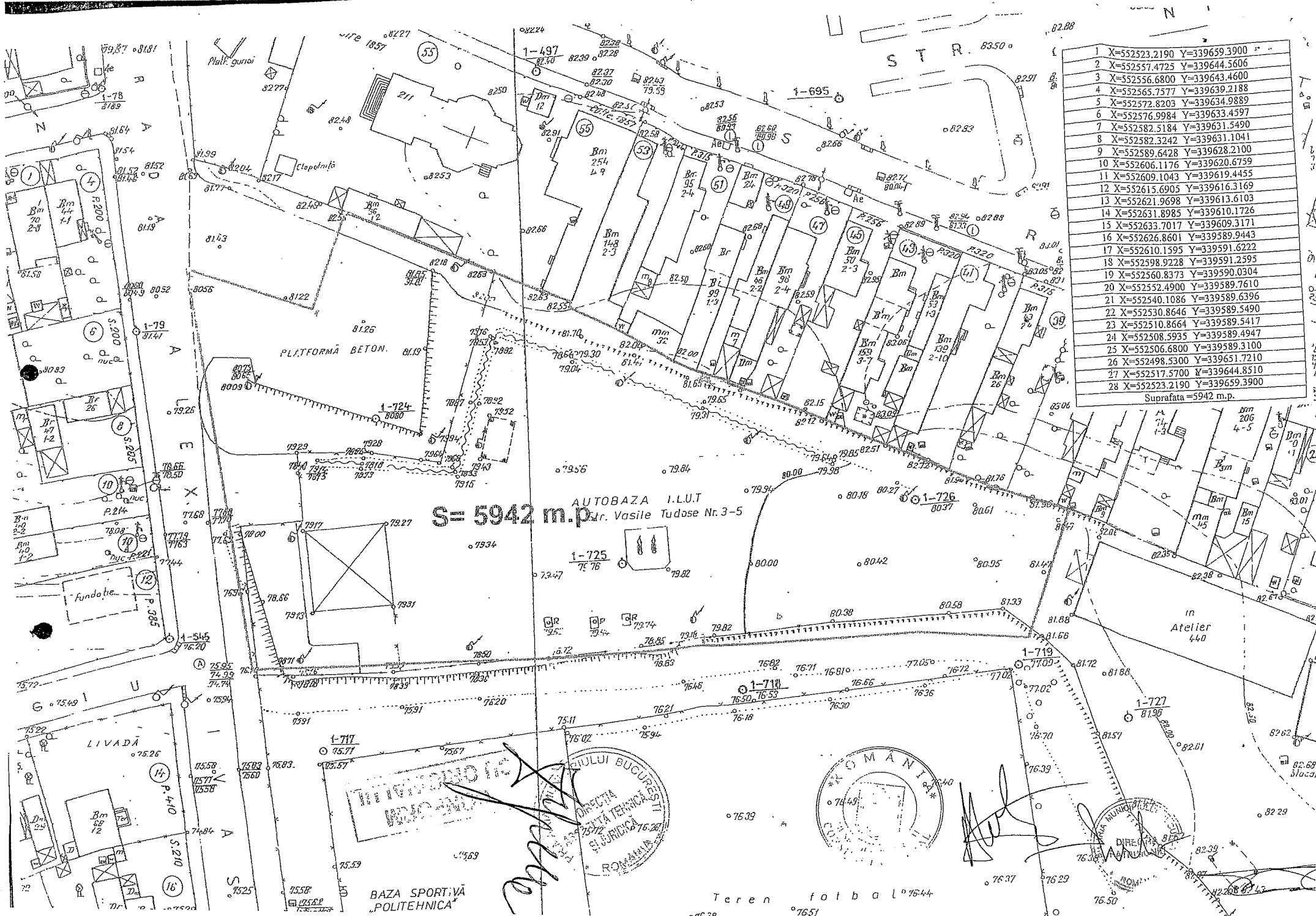

S = 5942 m.p.

1	X=552523.2190	Y=339659.3900
2	X=552557.4725	Y=339644.5606
3	X=552556.6800	Y=339643.4600
4	X=552565.7377	Y=339639.2188
5	X=552572.8203	Y=339634.9889
6	X=552576.9984	Y=339633.4597
7	X=552582.5184	Y=339631.5490
8	X=552582.3242	Y=339631.1041
9	X=552589.6428	Y=339628.2100
10	X=552606.1176	Y=339620.6759
11	X=552609.1043	Y=339619.4455
12	X=552615.6905	Y=339616.3169
13	X=552621.9698	Y=339613.6103
14	X=552631.8985	Y=339610.1726
15	X=552633.7017	Y=339609.3171
16	X=552626.8601	Y=339589.9443
17	X=552610.1595	Y=339591.6222
18	X=552598.9228	Y=339591.2595
19	X=552560.8373	Y=339590.0304
20	X=552552.4900	Y=339589.7610
21	X=552540.1086	Y=339589.6396
22	X=552530.8646	Y=339589.5490
23	X=552510.8664	Y=339589.5417
24	X=552508.5935	Y=339589.4947
25	X=552506.6800	Y=339589.3100
26	X=552498.5300	Y=339631.7210
27	X=552517.5700	Y=339644.8510
28	X=552523.2190	Y=339659.3900

Suprafata = 5942 m.p.

MINISTERUL
 DE INTERIORE
 SI JUSTITIA
 ROMANIA
 DIRECTIA
 DE INCHISURI SI
 PUNISCI
 SI JURNAL
 ROMANIA

ROMANIA
 COMUNA
 BUCURESTI

DIRECTIA
 DE INCHISURI SI
 PUNISCI
 ROMANIA

BAZA SPORTIVA POLITEHNICA

Teren fotbal 16.44

Atelier 440

PLATFORMA BETON.

AUTOBAZA I.L.U.T. tr. Vasile Tudose Nr. 3-5

LIVADA

PLAN DE SITUATIE

scara 1:500

Plan amplasament - imediata apropiere a
sos. Mihai Bravu nr. 612-616 sect. 4 Bucuresti

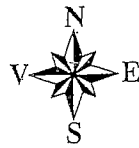

Peco
LUKOIL

Y=334850

COORDONATE CONTUR IMOBIL		
1	X=558132.4800	Y=334792.5400
2	X=558134.6638	Y=334796.6055
3	X=558158.7039	Y=334855.1222
4	X=558177.3293	Y=334846.9921
5	X=558153.7800	Y=334787.7400
6	X=558171.1374	Y=334776.1193
7	X=558168.5829	Y=334766.6540
8	X=558166.8000	Y=334765.3400
9	X=558164.8000	Y=334764.4600
10	X=558162.5400	Y=334764.1200
11	X=558160.3712	Y=334764.4289
12	X=558156.3408	Y=334766.5516
13	X=558154.5100	Y=334767.8200
14	X=558152.8913	Y=334769.3494
15	X=558149.8033	Y=334772.5089
16	X=558148.3806	Y=334774.1546
Suprafata = 1843 mp		

S = 1843 mp

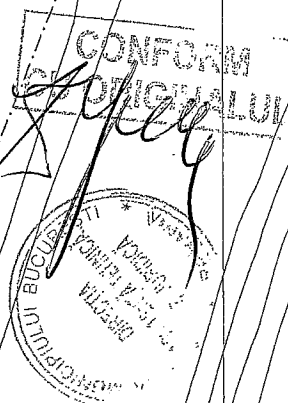

Y=334800

SOSEAUA MIHAI BRAVU

CALEA VAGARIA

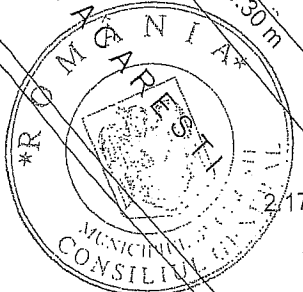

Y=334750

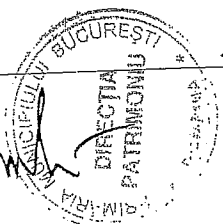

X=558150

X=558200

Document of 13.11.2012