

Amexă la H.C.S.M.B. 166/

Yellere

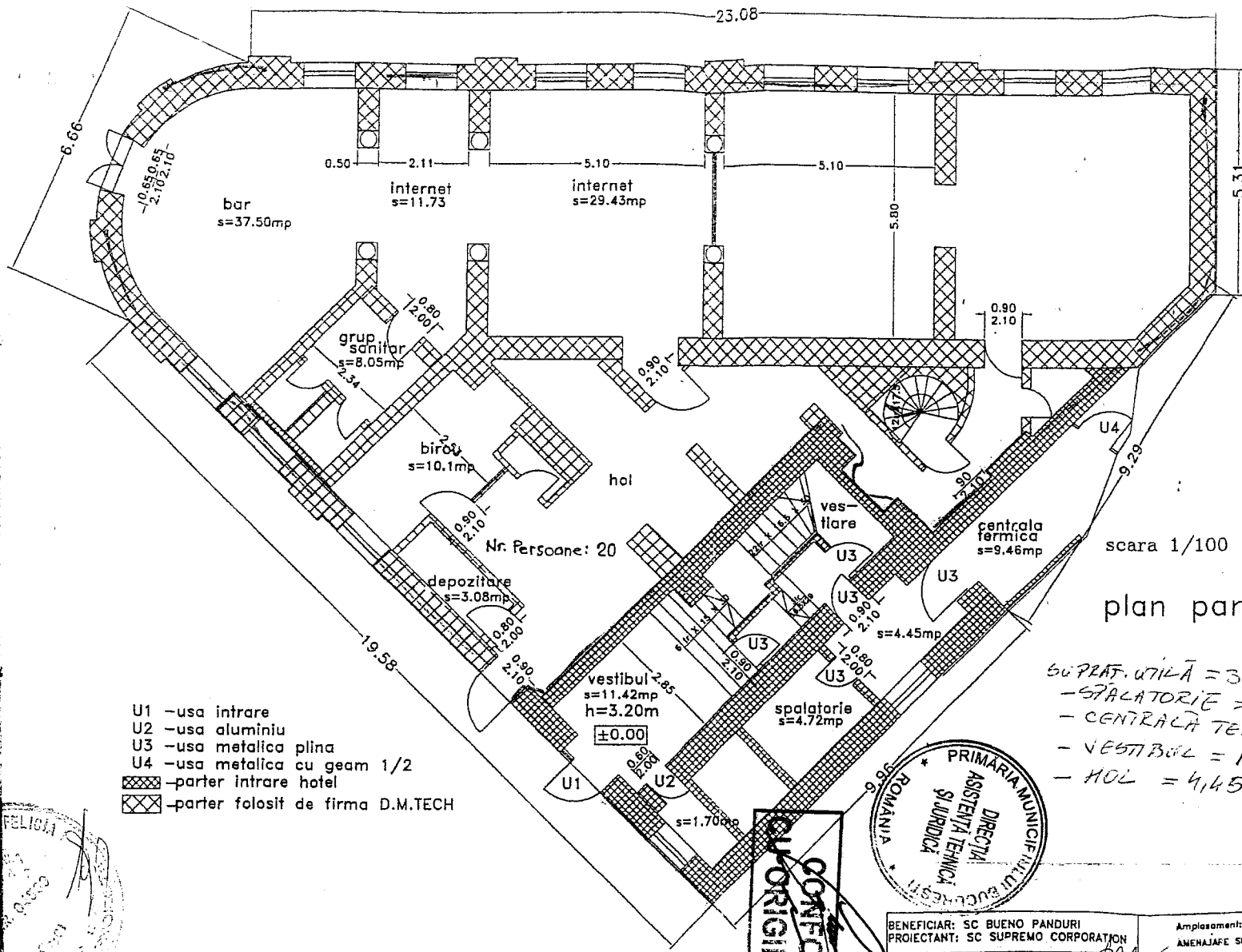

- U1 -usa intrare
- U2 -usa aluminiu
- U3 -usa metalica plina
- U4 -usa metalica cu geam 1/2
- ▨ -parter intrare hotel
- ▨ -parter folosit de firma D.M.TECH

scara 1/100
plan parter

SUPRAF. UTILA = 31,75 mp.
 - STALATORIE = 4,72 mp
 - CENTRALA TERMICA = 9,46 mp
 - VESTIBUL = 11,42 mp
 - HOL = 4,45 mp

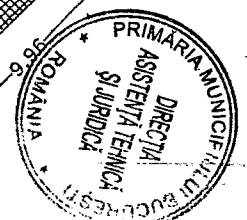
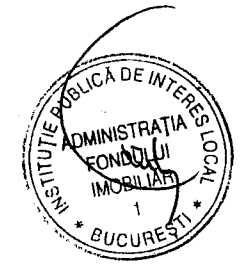

CONFIRMAT ORIGINALUL

BENEFICIAR: SC BUENO PANDURIA		Amplasament: Calea Plevnei 10, sector 5	FAZA PAC
PROIECTANT: SC SUPREMO CORPORATION			AMENAJARE SI MODERNIZARE CONSTRUCTIE
proiectat	arch. Mariana Iftimia Ileg	PLAN PARTER	scara 1/100
desenat	cond. arch. Mihaela Anghel		

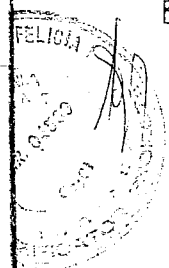

Amexă la n. 16/12
 yfell

S.C. YUORHOTELS S.R.L.
 B-DUL REGINA ELISABETA NR. 75, SECTOR 5
 BUCURESTI

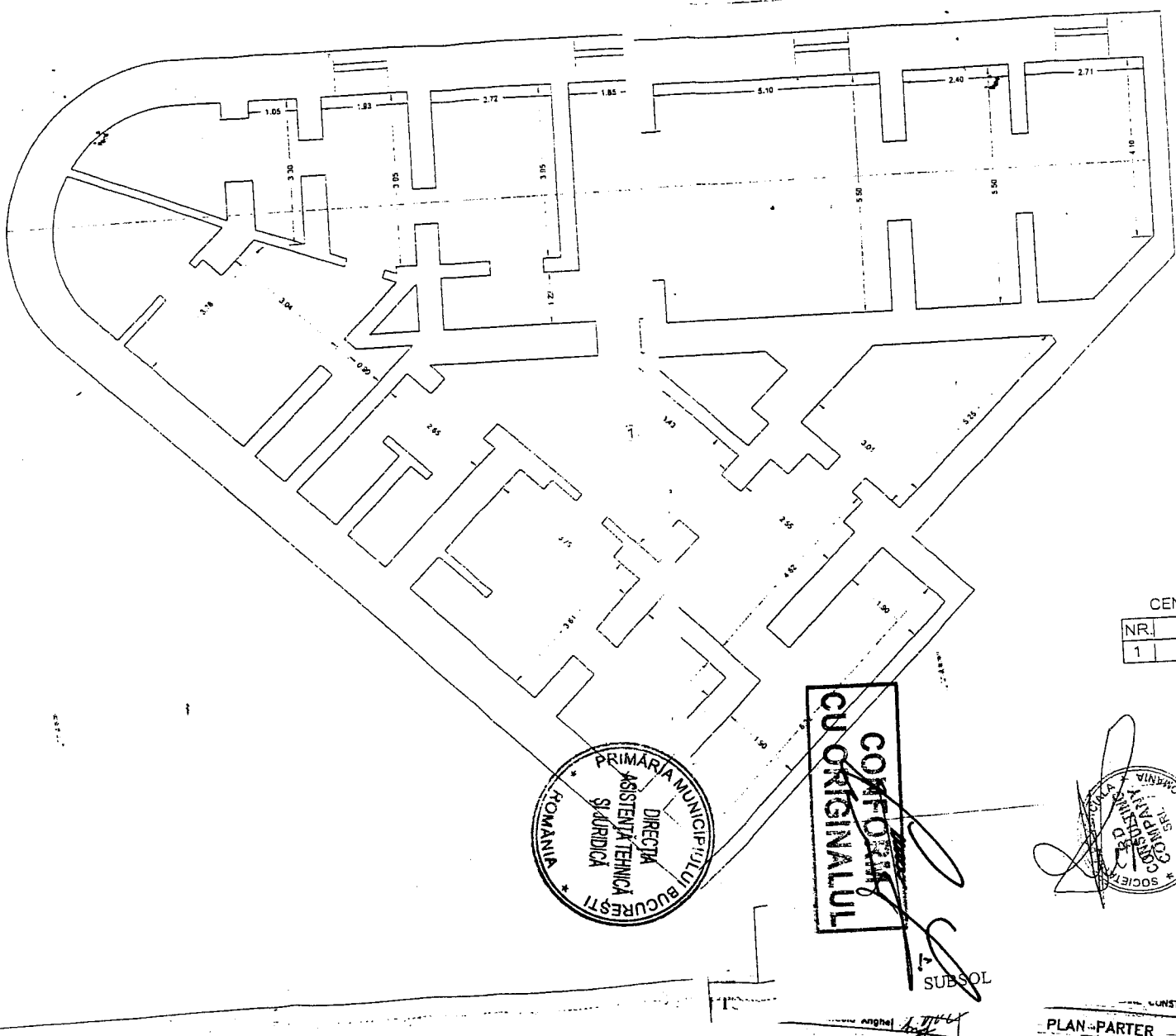

CENTRALIZATOR SUPRAFETE		
NR.	DESTINATIE	SUPRAFATA (m ²)
1	Subsol	223.74

S constr. = 335.15 m²



CONFIRMAT
 CU ORIGINALUL

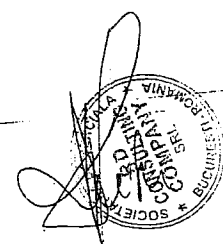

SUBSOL

CONSTRUCTIE
 PLAN-PARTER
 FAZA PAC
 pr.130/2001
 scara 1/100
 data 04/2002