

# P.U.D. - LOCUINTE INDIVIDUALE P+1-2E

## DRUMUL VALEA DANULUI Nr. 36, 38, 40, 42, SECTOR 6

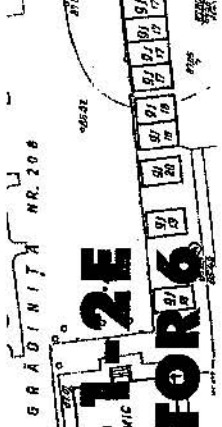

### LEGENDA:

- LIMITA P.U.D.
- PARCELE CE AU GENERAT PUD
- LIMITE PARCELE EXISTENTE
- LIMITE REZULTATE DUPA TRASARE CIRCULATI
- CAROSABIL / TROTUARE PROPUSE
- LOTURI - EXISTENTE
- CONSTRUCTII - EXISTENTE P+1E+M
- EDIFICABILE PROPUSE P+1E
- TROTUAR / CAROSABIL ACCES PRIVAT
- TERENURI CE VOR FACE OBIECTUL UNOR STUDII DE URBANISM VITAOARE
- INTERDICTIE DE CONSTRUIRE - TERENURI PROPUSE PT TRANSFER IN DOMENIU PUBLIC - LARGIRE PROSPECT STR. VALEA DANULUI

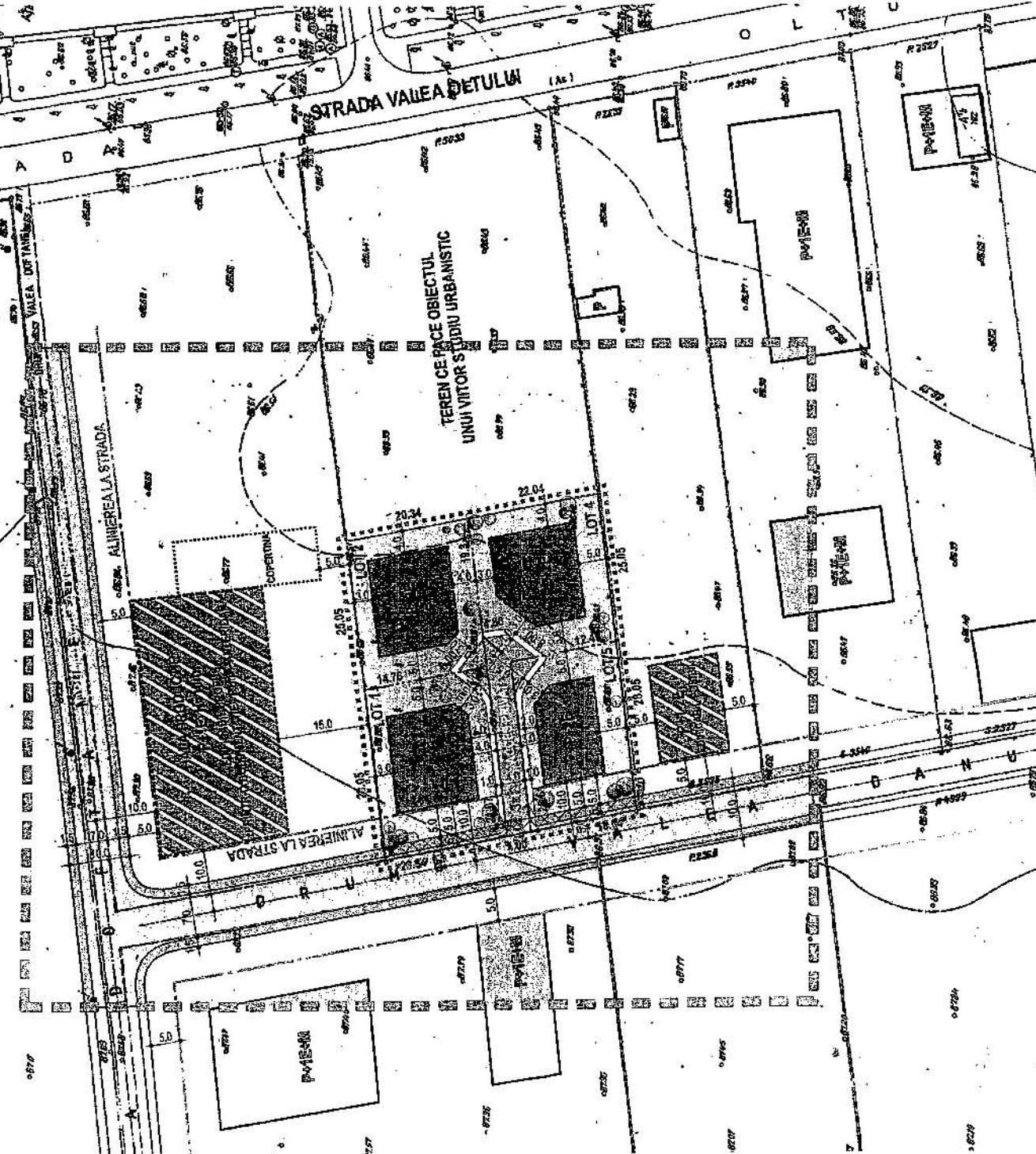

<b>LOT 1</b>	<ul style="list-style-type: none"> <li>- SUPRAFATA LOT - 588,0 mp</li> <li>- EDIFICABIL - 214,8 mp</li> <li>- CURTIE - 272,6 mp</li> <li>- CIRCULATI - 16,2 mp</li> <li>- POT - 37,5%</li> <li>- CUT - 1,12</li> <li>- H max - P+2E</li> <li>- S TRANSFERABILA CATRE DOMENIU PUBLIC - 40,7 mp</li> </ul>
<b>LOT 2</b>	<ul style="list-style-type: none"> <li>- SUPRAFATA LOT - 510,0 mp</li> <li>- EDIFICABIL - 212,0 mp</li> <li>- CURTIE - 216,5 mp</li> <li>- CIRCULATI - 21,5 mp</li> <li>- POT - 41,5%</li> <li>- CUT - 1,24</li> <li>- H max - P+2E</li> </ul>
<b>LOT 3a</b>	<ul style="list-style-type: none"> <li>- SUPRAFATA LOT - ACCES PRIVAT - 122,0 mp</li> <li>- S TRANSFERABILA CATRE DOMENIU PUBLIC - 8,0 mp</li> </ul>
<b>LOT 4</b>	<ul style="list-style-type: none"> <li>- SUPRAFATA LOT - 541,0 mp</li> <li>- EDIFICABIL - 206,0 mp</li> <li>- CURTIE - 306,2 mp</li> <li>- CIRCULATI - 26,8 mp</li> <li>- POT - 38,0%</li> <li>- CUT - 1,14</li> <li>- H max - P+2E</li> </ul>
<b>LOT 5</b>	<ul style="list-style-type: none"> <li>- SUPRAFATA LOT - 505,0 mp</li> <li>- EDIFICABIL - 157,0 mp</li> <li>- CURTIE - 270,7 mp</li> <li>- CIRCULATI - 77,3 mp</li> <li>- POT - 37,3%</li> <li>- CUT - 0,84</li> <li>- H max - P+2E</li> <li>- S TRANSFERABILA CATRE DOMENIU PUBLIC - 36,0 mp</li> </ul>
<b>INCINTA</b>	<ul style="list-style-type: none"> <li>- SUPRAFATA TOTALA INCINTA - 2246,0 mp</li> <li>- CIRCULATIE INCINTA - 305,5 mp</li> <li>- din care - CAROSABIL AUTO - 174,2 mp</li> <li>- TROTUAR - 131,3 mp</li> <li>- TRANSFER TEREN IN INTERES PUBLIC - 84,7 mp (pt. DRUMUL VALEA DANULUI)</li> </ul>

**S.C. ATRIUM B S.R.L.**  
 PROIECTAT de ing. D. Păunulescu  
 OBSERVAT de ing. G. Găvruta

Denumirea proiect: "P.U.D. - LOCUINTE INDIVIDUALE P+1-2E" DRUMUL VALEA DANULUI NR. 36, 38, 40, 42, SECTOR 6 - BUCURESTI  
 Beneficiar: ALI AL HASSANU, S.C FRASCO DE IMPEX SRL, STEFAN MITRACHE

Sc. 1:500  
 Data: noi 2005

REGLEMENTARI DE URBANISM A5