

ANEXA

de H.C.L. Sector 6 nr: 147/20.08.2006

Plan de amplasament si delimitare a imobilului
Scara 1:500

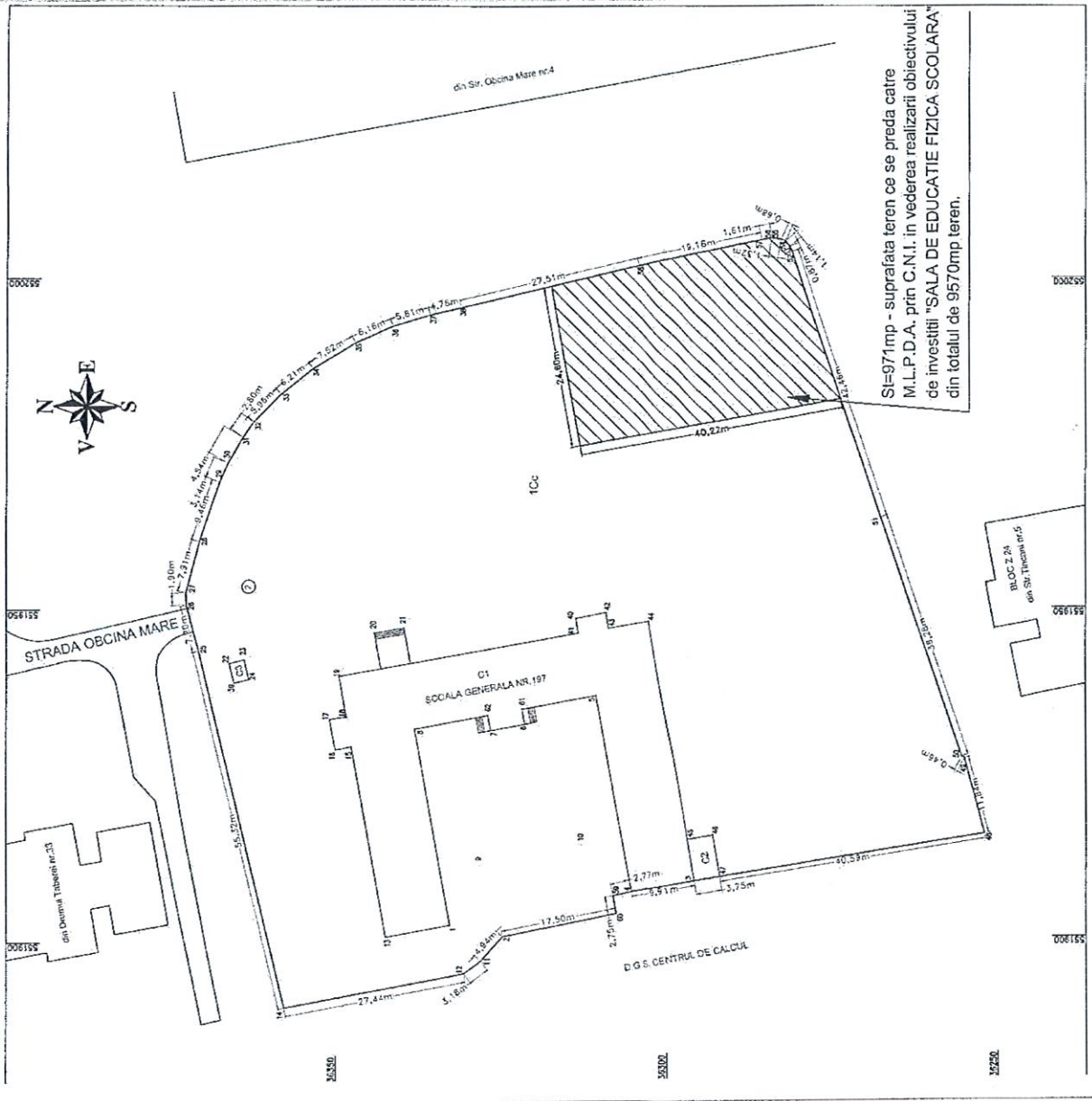

PRESEDINTE DE SEDINTA



Nr. cadastral:	Suprafata masurata(mp)
9570	9570
Str. Obcina Mare nr.2, Sector 6, Bucuresti ȘCOALA GENERALA NR.197	
Cantona Funciara nr. UAT Sector 6	

A. Date referitoare la teren

Nr. parcela	Categorie	Suprafata (mp)	Valoarea de impozitare(lei)	Mentiiuni
1	Cc	9570		Imprejmuit cu gard beton
Total		9570		

B. Date referitoare la constructii

Cod constr.	Suprafata construita la sol (mp)	Valoarea de impozitare(lei)	Mentiiuni
C1	1093		Școala Generala, CAS
C2	24		Magazie, CA
C3	7		Ghena, CA
Total	1124		

INVENTAR DE COORDONATE
Sistem de proiectie: Stereom, Bucuresti

Nr. Pct.	Pentru (metri)	Coordonate punctul contur		Lungimi laterale (m)
		X (m)	Y (m)	
3	651032,232	336324,702	0,070	0,070
4	551997,077	336325,460	2,715	2,715
5	551998,451	336325,172	17,465	17,465
6	551880,354	336324,871	17,465	17,465
7	551926,670	336324,172	3,177	3,177
8	551894,787	336325,721	27,441	27,441
9	551894,787	336325,721	27,441	27,441
10	551894,787	336325,721	27,441	27,441
11	551894,787	336325,721	27,441	27,441
12	551894,787	336325,721	27,441	27,441
13	551894,787	336325,721	27,441	27,441
14	551894,787	336325,721	27,441	27,441
15	551894,787	336325,721	27,441	27,441
16	551894,787	336325,721	27,441	27,441
17	551894,787	336325,721	27,441	27,441
18	551894,787	336325,721	27,441	27,441
19	551894,787	336325,721	27,441	27,441
20	551894,787	336325,721	27,441	27,441
21	551894,787	336325,721	27,441	27,441
22	551894,787	336325,721	27,441	27,441
23	551894,787	336325,721	27,441	27,441
24	551894,787	336325,721	27,441	27,441
25	551894,787	336325,721	27,441	27,441
26	551894,787	336325,721	27,441	27,441
27	551894,787	336325,721	27,441	27,441
28	551894,787	336325,721	27,441	27,441
29	551894,787	336325,721	27,441	27,441
30	551894,787	336325,721	27,441	27,441
31	551894,787	336325,721	27,441	27,441
32	551894,787	336325,721	27,441	27,441
33	551894,787	336325,721	27,441	27,441
34	551894,787	336325,721	27,441	27,441
35	551894,787	336325,721	27,441	27,441
36	551894,787	336325,721	27,441	27,441
37	551894,787	336325,721	27,441	27,441
38	551894,787	336325,721	27,441	27,441
39	551894,787	336325,721	27,441	27,441
40	551894,787	336325,721	27,441	27,441
41	551894,787	336325,721	27,441	27,441
42	551894,787	336325,721	27,441	27,441
43	551894,787	336325,721	27,441	27,441
44	551894,787	336325,721	27,441	27,441
45	551894,787	336325,721	27,441	27,441
46	551894,787	336325,721	27,441	27,441
47	551894,787	336325,721	27,441	27,441
48	551894,787	336325,721	27,441	27,441
49	551894,787	336325,721	27,441	27,441
50	551894,787	336325,721	27,441	27,441
51	551894,787	336325,721	27,441	27,441
52	551894,787	336325,721	27,441	27,441
53	551894,787	336325,721	27,441	27,441
54	551894,787	336325,721	27,441	27,441
55	551894,787	336325,721	27,441	27,441
56	551894,787	336325,721	27,441	27,441
57	551894,787	336325,721	27,441	27,441
58	551894,787	336325,721	27,441	27,441
59	551894,787	336325,721	27,441	27,441
60	551894,787	336325,721	27,441	27,441
61	551894,787	336325,721	27,441	27,441
62	551894,787	336325,721	27,441	27,441
63	551894,787	336325,721	27,441	27,441
64	551894,787	336325,721	27,441	27,441
65	551894,787	336325,721	27,441	27,441
66	551894,787	336325,721	27,441	27,441
67	551894,787	336325,721	27,441	27,441
68	551894,787	336325,721	27,441	27,441
69	551894,787	336325,721	27,441	27,441
70	551894,787	336325,721	27,441	27,441
71	551894,787	336325,721	27,441	27,441
72	551894,787	336325,721	27,441	27,441
73	551894,787	336325,721	27,441	27,441
74	551894,787	336325,721	27,441	27,441
75	551894,787	336325,721	27,441	27,441
76	551894,787	336325,721	27,441	27,441
77	551894,787	336325,721	27,441	27,441
78	551894,787	336325,721	27,441	27,441
79	551894,787	336325,721	27,441	27,441
80	551894,787	336325,721	27,441	27,441
81	551894,787	336325,721	27,441	27,441
82	551894,787	336325,721	27,441	27,441
83	551894,787	336325,721	27,441	27,441
84	551894,787	336325,721	27,441	27,441
85	551894,787	336325,721	27,441	27,441
86	551894,787	336325,721	27,441	27,441
87	551894,787	336325,721	27,441	27,441
88	551894,787	336325,721	27,441	27,441
89	551894,787	336325,721	27,441	27,441
90	551894,787	336325,721	27,441	27,441
91	551894,787	336325,721	27,441	27,441
92	551894,787	336325,721	27,441	27,441
93	551894,787	336325,721	27,441	27,441
94	551894,787	336325,721	27,441	27,441
95	551894,787	336325,721	27,441	27,441
96	551894,787	336325,721	27,441	27,441
97	551894,787	336325,721	27,441	27,441
98	551894,787	336325,721	27,441	27,441
99	551894,787	336325,721	27,441	27,441
100	551894,787	336325,721	27,441	27,441

Executant: S.C. URBAN-G.I.S. S.R.L. Data: Noiembrie 2007

Semnatura si stampila: [Stampa]

Se confirma suprafata din masuratori si introducerea imobilului in baza de date

Semnatura si Parafa

Stampila BCPI: [Stampa]