

PLAN DE AMPLASAMENT SI DELIMITARE A IMOBILULUI
SCARA 1 : 500

| | | |
|-------------------------|--|---|
| Nr. cadastral 214807 | Suprafata masurata 2469 mp. | Adresa Imobilului Strada Sfantul Dumitru nr. 2 |
| Cartea Funciara nr. | Unitatea Administrativ Teritoriala (UAT) Sector 3 | |

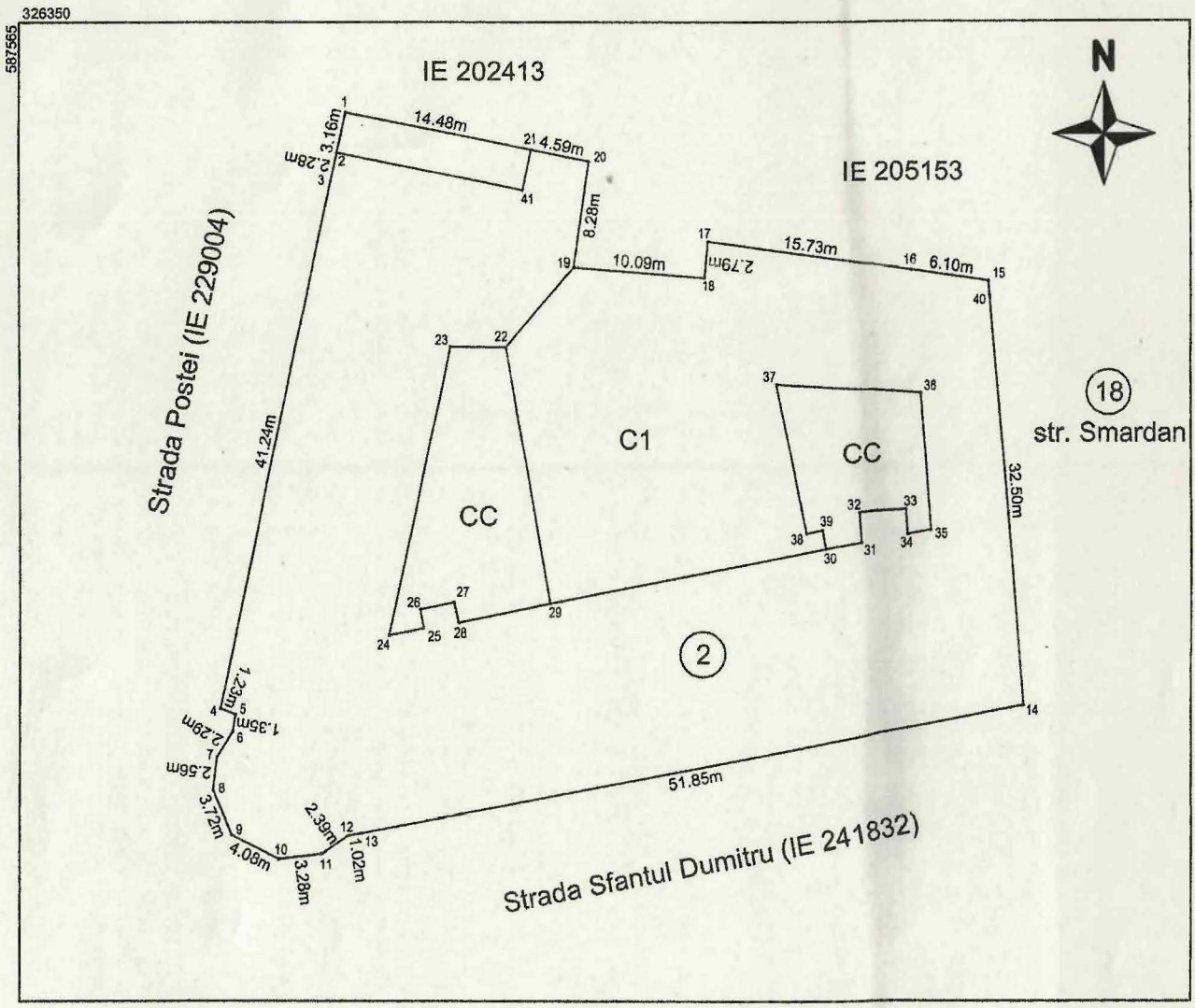



| A. Date referitoare la teren | | | |
|------------------------------|------------------------|-----------------|---|
| Nr. parcela | Categoria de folosinta | Suprafata (mp.) | Mentiuni |
| 1 | CC | 2469 mp | teren situat sub constructie si curtile de lumina |
| TOTAL | | 2469 mp | |

| B. Date referitoare la constructii | | | |
|------------------------------------|------------------------|------------------------------------|---|
| Cod constr. | Categoria de folosinta | Suprafata construita la sol (m.p.) | Mentiuni |
| C1 | CAS | 2146 mp | S. construita desfasurata = 10382 mp (S+P+Mz+3+M) |
| TOTAL | | 2146 mp | |

Suprafata totala masurata a imobilului = 2469 mp. Suprafata din acte a imobilului = mp.

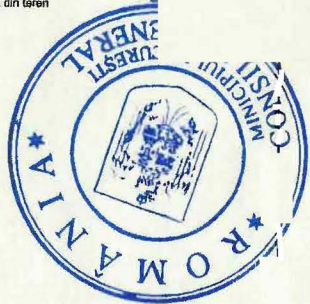
Executant:
Confirm executarea masuratorilor la teren, corectitudinea intocmirii documentatiei cadastrale si corespondenta acestora cu realitatea din teren

Data:

CALCULUL SUPRAFETELOR

Parcela (CC) Sf. Dumitru 2

| Nr. Pct. | Coordonate pct.de contur | | Lungimi latari D(i,i+1) |
|--------------------------|--------------------------|------------|-------------------------------|
| | X [m] | Y [m] | |
| 1 | 326343.044 | 587589.825 | 3.160 |
| 2 | 326339.949 | 587589.187 | 2.277 |
| 3 | 326337.719 | 587588.728 | 41.237 |
| 4 | 326297.330 | 587580.408 | 1.230 |
| 5 | 326296.863 | 587581.546 | 1.354 |
| 6 | 326295.526 | 587581.334 | 2.291 |
| 7 | 326293.561 | 587580.156 | 2.556 |
| 8 | 326291.020 | 587579.881 | 3.720 |
| 9 | 326287.579 | 587581.295 | 4.084 |
| 10 | 326285.754 | 587584.949 | 3.276 |
| 11 | 326286.166 | 587588.199 | 2.387 |
| 12 | 326287.556 | 587590.139 | 1.024 |
| 13 | 326287.711 | 587591.151 | 51.851 |
| 14 | 326297.612 | 587642.048 | 32.501 |
| 15 | 326329.994 | 587639.266 | 6.095 |
| 16 | 326330.835 | 587633.229 | 15.732 |
| 17 | 326333.056 | 587617.655 | 2.789 |
| 18 | 326330.280 | 587617.387 | 10.094 |
| 19 | 326331.084 | 587607.325 | 8.280 |
| 20 | 326339.278 | 587608.514 | 4.585 |
| 21 | 326340.183 | 587604.019 | 14.479 |
| S (CC)=2469mp P=215.002m | | | |



Parcela (C1) S+P+Mz+3+M

| Nr. Pct. | Coordonate pct.de contur | | Lungimi latari D(i,i+1) |
|--------------------------|--------------------------|------------|-------------------------------|
| | X [m] | Y [m] | |
| 19 | 326331.084 | 587607.325 | 8.166 |
| 22 | 326324.879 | 587602.017 | 4.226 |
| 23 | 326324.949 | 587597.792 | 22.532 |
| 24 | 326302.895 | 587593.174 | 2.688 |
| 25 | 326303.432 | 587595.808 | 1.450 |
| 26 | 326304.852 | 587595.513 | 2.649 |
| 27 | 326305.391 | 587598.107 | 1.594 |
| 28 | 326303.830 | 587598.432 | 7.262 |
| 29 | 326305.307 | 587605.542 | 21.607 |
| 30 | 326309.480 | 587626.742 | 2.626 |
| 31 | 326309.945 | 587629.327 | 2.360 |
| 32 | 326312.298 | 587629.148 | 3.610 |
| 33 | 326312.471 | 587632.754 | 1.889 |
| 34 | 326310.587 | 587632.898 | 1.830 |
| 35 | 326310.910 | 587634.699 | 10.485 |
| 36 | 326321.365 | 587633.900 | 10.996 |
| 37 | 326322.084 | 587622.928 | 11.651 |
| 38 | 326310.664 | 587625.238 | 1.240 |
| 39 | 326310.910 | 587626.453 | 1.459 |
| 30 | 326309.480 | 587626.742 | 21.607 |
| 29 | 326305.307 | 587605.542 | 19.887 |
| 22 | 326324.879 | 587602.017 | 8.166 |
| 19 | 326331.084 | 587607.325 | 10.094 |
| 18 | 326330.280 | 587617.387 | 2.789 |
| 17 | 326333.056 | 587617.655 | 15.732 |
| 16 | 326330.835 | 587633.229 | 6.095 |
| 15 | 326329.994 | 587639.266 | 1.136 |
| 40 | 326328.862 | 587639.363 | 31.365 |
| 14 | 326297.612 | 587642.048 | 51.851 |
| 13 | 326287.711 | 587591.151 | 1.024 |
| 12 | 326287.556 | 587590.139 | 2.387 |
| 11 | 326286.166 | 587588.199 | 3.276 |
| 10 | 326285.754 | 587584.949 | 4.084 |
| 9 | 326287.579 | 587581.295 | 3.720 |
| 8 | 326291.020 | 587579.881 | 2.556 |
| 7 | 326293.561 | 587580.156 | 2.291 |
| 6 | 326295.526 | 587581.334 | 1.354 |
| 5 | 326296.863 | 587581.546 | 1.230 |
| 4 | 326297.330 | 587580.408 | 41.237 |
| 3 | 326337.719 | 587588.728 | 2.277 |
| 2 | 326339.949 | 587589.187 | 14.466 |
| 41 | 326336.982 | 587603.345 | 3.271 |
| 21 | 326340.183 | 587604.019 | 4.585 |
| 20 | 326339.278 | 587608.514 | 8.280 |
| S (C1)=2146mp P=385.080m | | | |

