

America la HCGMB nr. 519/29.09.2022

S3

PLAN DE AMPLASAMENT SI DELIMITARE A IMOBILULUI
ANEXA 11
Scara 1:500

Nr. cadastral		Suprafata măsurată		Adresa imobilului	
225/188		15207		Municipiul Bucuresti, Bulevardul Regina Elisabeta, Sector 3.	
Cartea Funciară nr.:		U.A.T.		Sector 3, Bucuresti	
A. Date referitoare la teren					
Nr. Parcele	Categoria de folosinta	Suprafata (mp)	Valoarea de impozitare (Lei)	Mentiuni	
1	Dr	15207	-	Imprejmuit partial, delimitat de proprietari private S= 353 mp reprezinta spatii verde (alveole pomi) S= 9278 mp reprezinta trotuar S= 5577 mp reprezinta partea carosabila	
TOTAL		15207			
B. Date referitoare la constructii					
Cod constructie	Suprafata constructia la sol (mp)	Valoarea de impozitare (Lei)	Mentiuni		
TOTAL					

INVENTAR DE COORDONATE
SISTEM DE PROIECTIE STEREOGRAFIC 1970
NA
Insusitor cadastru

Nr. Pct.	Coordonate pct.de contur		Lungimi laterale D(i,i+1)	Nr. Pct.	Coordonate pct.de contur		Lungimi laterale D(i,i+1)	Nr. Pct.	Coordonate pct.de contur		Lungimi laterale D(i,i+1)	Nr. Pct.	Coordonate pct.de contur		Lungimi laterale D(i,i+1)
	X [m]	Y [m]			X [m]	Y [m]			X [m]	Y [m]			X [m]	Y [m]	
177	326735.325	587782.688	4.22	206	326794.428	587808.899	0.72	108	326693.143	587560.232	6.48	81	326706.808	587745.620	2.86
178	326734.425	587778.617	5.23	207	326794.428	587808.899	0.40	118	326693.813	587566.779	4.75	80	326704.108	587766.559	0.58
179	326739.470	587772.237	1.24	208	326794.428	587808.899	0.78	107	326694.303	587571.399	1.95	79	326703.903	587747.103	1.14
180	326740.610	587781.323	5.27	36	326793.960	587839.491	7.00	106	326695.279	587573.084	3.38	78	326704.655	587747.957	14.60
181	326735.329	587782.703	42.32	35	326792.137	587832.730	0.40	105	326696.112	587576.364	0.65	77	326695.835	587759.590	16.37
182	326716.083	587823.658	9.21	209	326792.137	587832.730	6.63	104	326696.761	587576.266	36.42	76	326696.626	587775.113	0.40
61	326735.111	587824.656	42.22	210	326790.685	587826.247	0.40	103	326706.388	587611.410	1.04	75	326691.021	58775.189	1.56
183	326728.309	587824.988	21.48	34	326790.296	587826.359	4.45	102	326706.678	587612.411	0.33	74	326690.814	587776.740	1.16
184	326745.969	587814.693	4.38	33	326789.135	587822.065	0.81	101	326706.771	587612.730	12.47	73	326689.657	587776.773	0.37
185	326750.123	587809.291	4.40	32	326788.156	587822.269	9.71	100	326710.153	587624.531	24.04	72	326689.374	587770.006	1.31
186	326751.354	587813.513	4.44	30	326786.589	587812.677	4.45	117	326716.863	587620.293	2.80	70	326689.750	587790.610	0.55
187	326747.975	587814.793	21.39	29	326785.997	587808.843	2.80	98	326717.243	587625.815	9.96	69	326690.114	587780.025	2.19
60	326738.326	587824.990	4.00	28	326785.135	587807.450	31.51	97	326718.532	587626.944	10.29	142	326691.685	587787.038	15.83
59	326730.464	587829.292	0.27	27	326779.757	587772.270	4.27	96	326708.412	587664.784	1.53	143	326706.093	587780.487	1.79
58	326731.039	587829.050	9.87	26	326775.632	587778.391	18.19	119	326707.320	587665.852	3.17	144	326705.648	587787.758	1.19
57	326734.853	587838.156	18.56	25	326772.797	587760.854	4.52	120	326707.461	587669.021	9.27	145	326706.798	587778.451	2.61
56	326739.070	587847.827	16.23	24	326775.141	587759.613	31.31	121	326707.873	587678.284	14.95	146	326706.212	587755.908	4.76
55	326745.125	587862.887	5.87	23	326766.624	587729.484	2.80	122	326710.148	587693.063	11.27	147	326710.848	587744.818	1.76
54	326749.573	587866.725	17.40	22	326763.928	587730.248	4.37	123	326712.078	587704.162	4.54	148	326711.278	587767.329	2.30
188	326744.965	587849.951	26.20	20	326762.758	587726.033	0.69	124	326707.608	587704.976	10.09	149	326709.043	587777.109	2.59
190	326734.732	587825.829	1.55	21	326762.089	587726.217	1.55	125	326705.799	587695.049	16.24	150	326709.634	587779.632	3.64
191	326738.946	587824.052	46.18	211	326760.357	587726.004	8.35	126	326703.227	587679.012	4.69	151	326706.096	587780.997	15.83
192	326749.159	587848.156	17.40	212	326757.965	587717.965	1.75	127	326707.063	587678.206	9.27	68	326691.685	587787.048	4.32
193	326744.974	587849.947	17.40	18	326759.402	587716.630	0.72	128	326707.451	587669.022	3.16	67	326692.859	587791.209	15.50
188	326749.584	587866.726	3.31	19	326760.091	587716.416	4.40	129	326707.311	587665.861	2.03	152	326707.702	587786.757	1.76
53	326752.875	587867.077	5.24	17	326758.790	587712.213	0.93	130	326705.860	587667.380	2.96	153	326707.270	587785.554	1.18
52	326760.300	587811.048	5.99	213	326761.587	587711.099	0.76	95A	326705.225	587670.175	4.41	154	326708.410	587784.742	3.83
51	326760.458	587866.741	17.85	214	326761.393	587710.760	0.30	95	326701.309	587665.100	4.64	155	326707.470	587781.031	3.66
50	326778.290	587867.557	0.95	215	326761.683	587710.678	3.90	116	326696.694	587664.638	0.35	156	326711.025	587780.146	1.75
49	326779.236	587867.633	1.22	216	326760.665	587709.918	0.50	94	326696.346	587664.003	19.53	157	326711.466	587781.841	1.20
48	326778.551	587866.627	18.39	16	326760.375	587706.995	1.30	93	326695.386	587683.891	0.75	158	326710.303	587782.153	3.82
194	326777.542	587848.261	12.92	15	326759.999	587705.747	2.85	92	326698.669	587684.106	25.02	159	326711.257	587785.854	3.67
195	326776.730	587835.365	1.01	14	326757.243	587706.490	38.37	91	326705.187	587708.712	0.75	160	326707.704	587786.767	15.50
47	326777.345	587834.365	1.01	13	326747.092	587699.490	8.87	90	326702.470	587708.927	4.42	161	326692.861	587791.219	11.59
196	326777.968	587835.209	1.17	13A	326752.059	587662.143	6.10	89	326702.869	587711.310	17.75	162	326694.941	587802.617	17.79
197	32678.214	587836.348	5.70	13B	326746.844	587663.174	3.18	88	326703.586	587711.095	14.75	163	326711.152	587795.297	2.59
198	326779.930	587841.780	6.63	12	326745.270	587660.888	10.18	138	326710.516	587710.560	5.11	164	326710.516	587792.787	1.21
199	326782.231	587847.999	6.32	11	326742.239	587658.279	3.64	137	326723.240	587709.223	5.15	165	326709.347	587793.081	1.82
200	326784.869	587853.746	11.30	10	326738.932	587649.699	1.42	132	326724.589	587714.193	1.19	166	326708.903	587791.320	1.19
46	326791.254	587863.065	0.92	9	326737.653	587649.083	1.49	133	326719.661	587715.530	5.14	167	326710.050	587791.012	3.89
45	326791.109	587863.975	8.87	11A	326736.790	587647.963	2.05	134	326718.225	587710.570	14.75	168	326709.125	587787.332	4.73
44	326797.125	587847.063	3.48	8	326735.320	587646.424	80.20	135	326705.588	587711.105	18.02	169	326713.695	587786.030	1.78
43	326797.377	587854.010	3.24	7	326734.172	587646.063	9.51	87	326706.379	587728.903	9.83	170	326714.134	587787.754	2.31
42	326798.256	587850.840	0.51	6	326731.778	587559.860	0.31	86	326707.903	587738.619	0.72	171	326711.909	587788.377	4.72
41	326799.301	587845.615	0.76	11B	326731.792	587559.553	2.67	85	326707.218	587738.222	0.67	172	326713.093	587792.900	1.19
40	326798.446	587845.654	0.76	5	326731.915	587556.887	3.31	84	326706.950	587739.042	2.48	173	326714.245	587792.660	1.83
39	326797.699	587845.536	0.76	4	326731.181	587553.824	1.75	83	326707.951	587741.306	0.51	174	326714.717	587794.424	3.67
201	326796.993	587845.266	0.78	3	326734.210	587552.413	3.21	82	326708.405	587741.340	19.48	175	326711.154	587795.307	17.79
202	326796.354	587844.844	0.75	2	326736.789	587550.909	9.71	136	326727.790	587744.025	4.68	66	326694.943	587802.627	4.26
38	326795.823	587844.322	1.05	1	326737.042	587540.798	3.58	137	326723.245	587742.797	9.59	65	326697.989	587805.608	8.79
37	326795.227	587843.462	1.05	112	326733.588	587541.655	3.21	138	326733.353	587747.256	4.66	64	326703.925	587812.095	7.72
203	326794.735	587842.518	0.56	111	326740.436	587542.272	18.12	139	326730.872	587748.254	4.65	63	326709.950	587816.239	7.79
204	326794.544	587842.011	0.56	110	326694.237	587540.025	3.12	140	326732.791	587744.025	19.49	176	326716.794	587820.653	42.33
205	326794.441	587841.464	0.56	109	326691.291	587531.485	8.94	141	326708.401	587741.550	4.37				

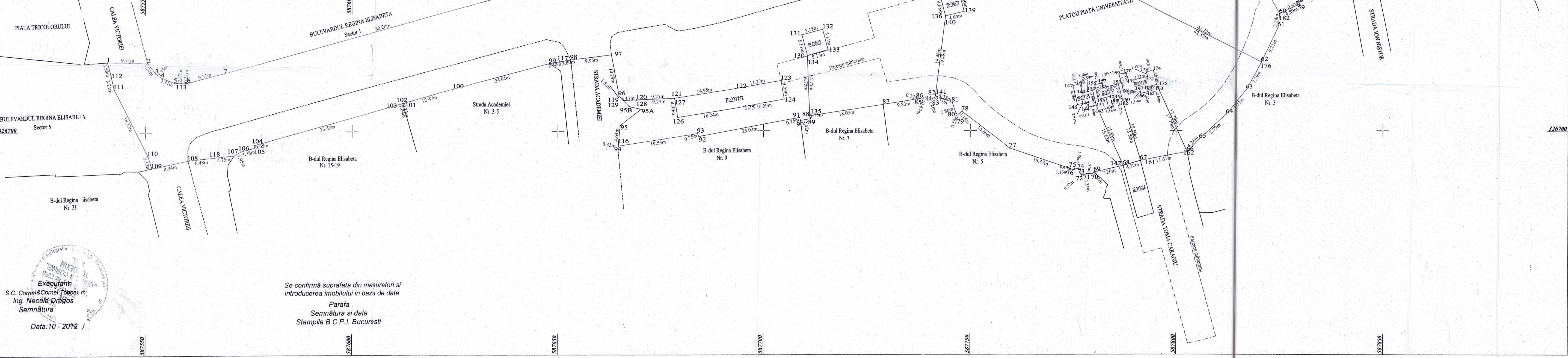

Se confirmă suprafata din măsuratori si
introducerea imobilului in baza de date
Parafa
Semnătura si data
Stampila B.C.P.I. Bucuresti

Data: 10 - 2018 J

24.08.2022

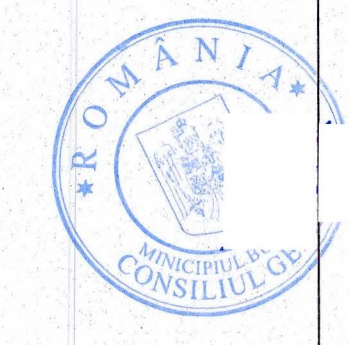

PLAN DE AMPLASAMENT SI DELIMITARE A IMOBILULUI Scara 1:1000

ANEXA 11

Nr. cadastral	Suprafata măsurată	Adresa imobilului	
228602	19414	Municipiul Bucuresti, B-dul Regina Elisabeta, Sector 5.	
Cartea Funciară nr:	228602	U.A.T.	Sector 5
A. Date referitoare la teren			
Nr. Parcelă	Categoria de folosinta	Suprafata(mp)	Valoare de impozitare(Lei)
1	Dr	19414	-
Mentiuni Imprejmuiri partial, delimitat de proprietati private S=8284mp reprezinta trotuar, S=334 mp reprezinta spatiu verde, S=10796mp reprezinta partea carosabila Actualizare I.E. 228602			
TOTAL		19414	-
B. Date referitoare la constructii			
Cod constructie	Destinatia	Suprafata construita la sol(mp)	Mentiuni
TOTAL		-	-

Executant:
S.C. Cornel & Cornel Topocon SRL
Ing. Stroescu Doros
Semnatura si Stampila

Oficiul de Cadastru si Publicitate Imobiliară
BUCUREȘTI
PIELEANU DOINA
Inspector de cadastru
Semnatura si data
Stampila B.C.P.I. Bucuresti

29.07.2016

29832/ 27.07.2016

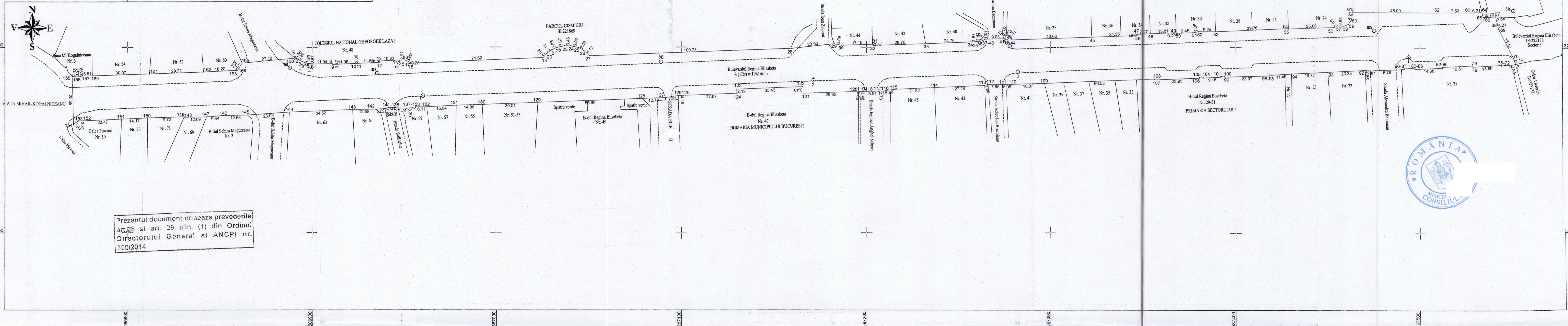
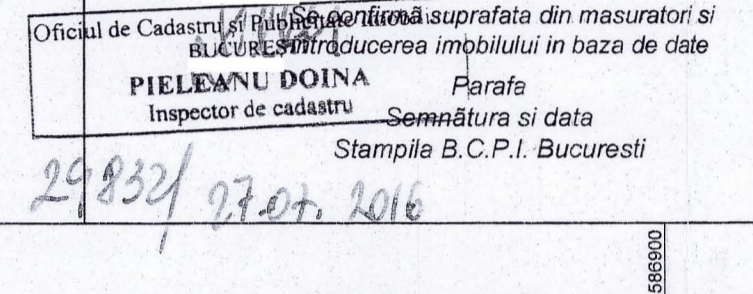

Prezentul document urmeaza prevederile
art.28 si art. 29 alin. (1) din Ordinul
Directorului General al ANCP I nr.
700/2014

